

Reo II Recliner

Assembly | User Guide

Two people are required for safe assembly

Opening Boxes:

DO NOT use a knife to open the packaging as you may damage your furniture.
Peel off the tape, then lift & separate the cardboard flaps to open.

Assemble your furniture by following the instructions below.

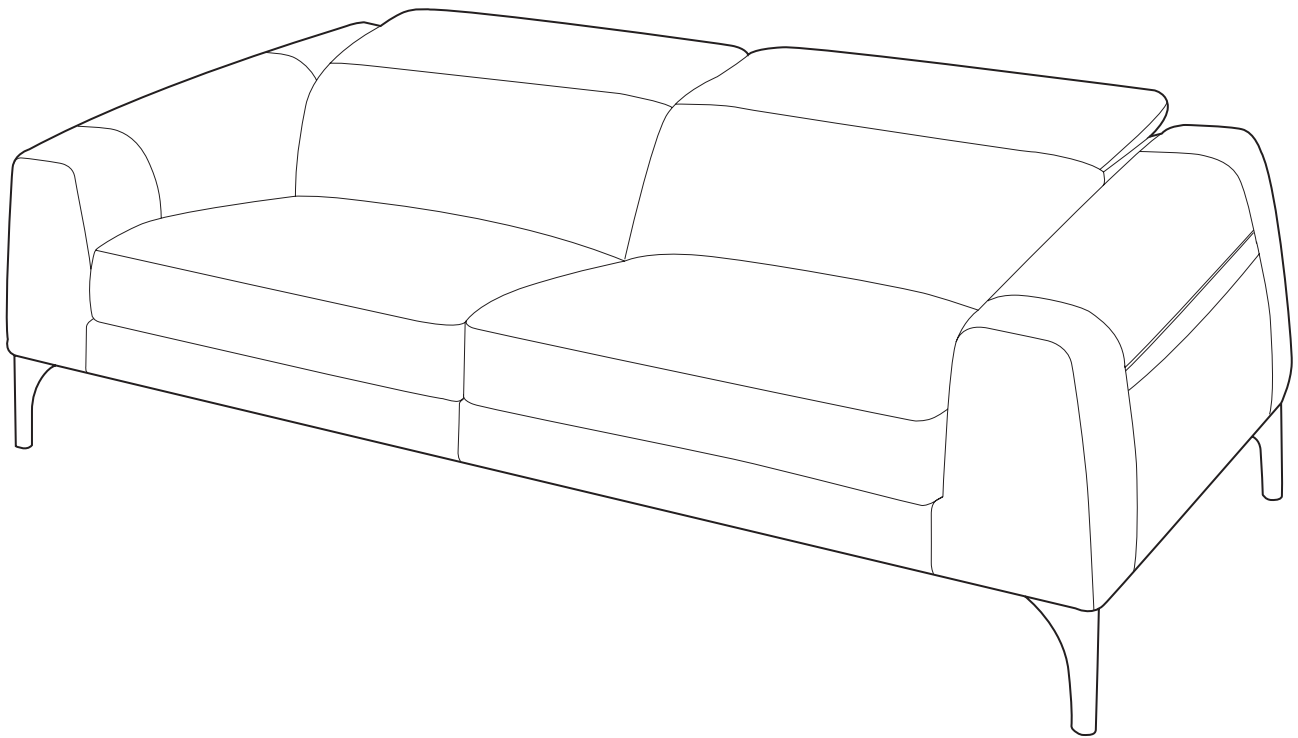

Contents

Assembly	3
Accessories and Storage	6
Connecting to Power	7
Connecting to Battery Pack- Smart	8
Connecting to Battery Pack	9
Operation	10
Frequently asked Questions (FAQ)	11
Warning	14

WARNING



Do not sit on footrest when in open reclined/extended position.
MAXIMUM LOAD 15kg.

Always **RETRACT FOOTREST** prior to standing.

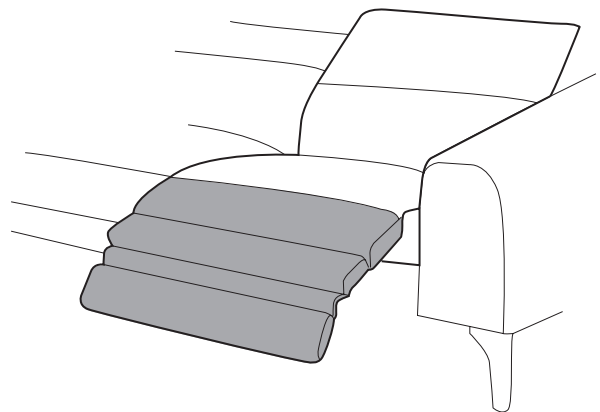

OBSTRUCTION AVOIDANCE



Always check for obstructions that may interfere with the recliner closing. If the recliner does not function properly, there may be an obstruction.

REMOVE OBSTRUCTION BEFORE FURTHER OPERATION

Obstructions can cause serious damage to your recliner.

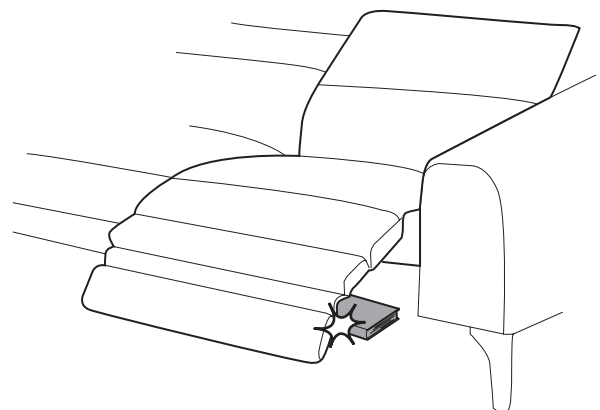

Assembly

2 SEATER / 2.5 SEATER

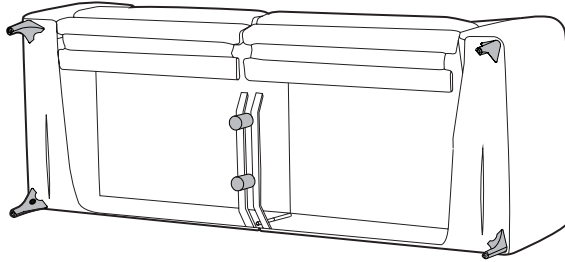
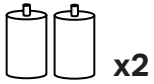
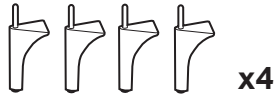

3 SEATER

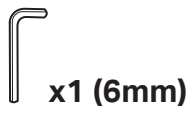
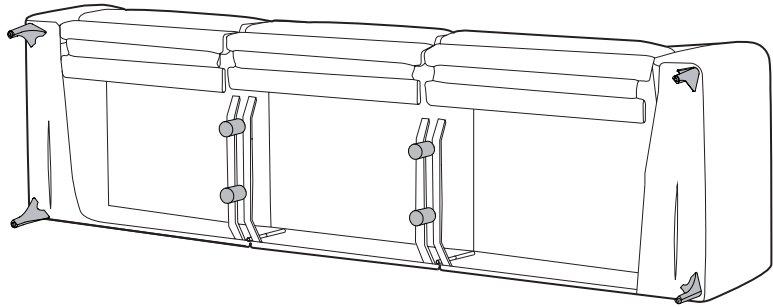
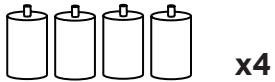
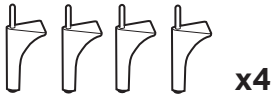

1

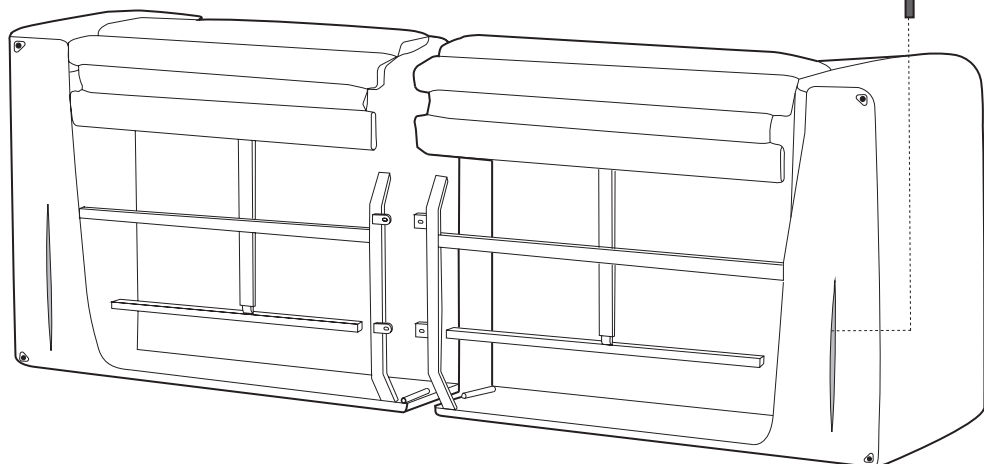
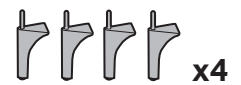
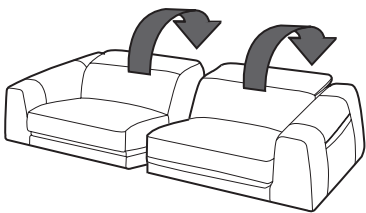

2

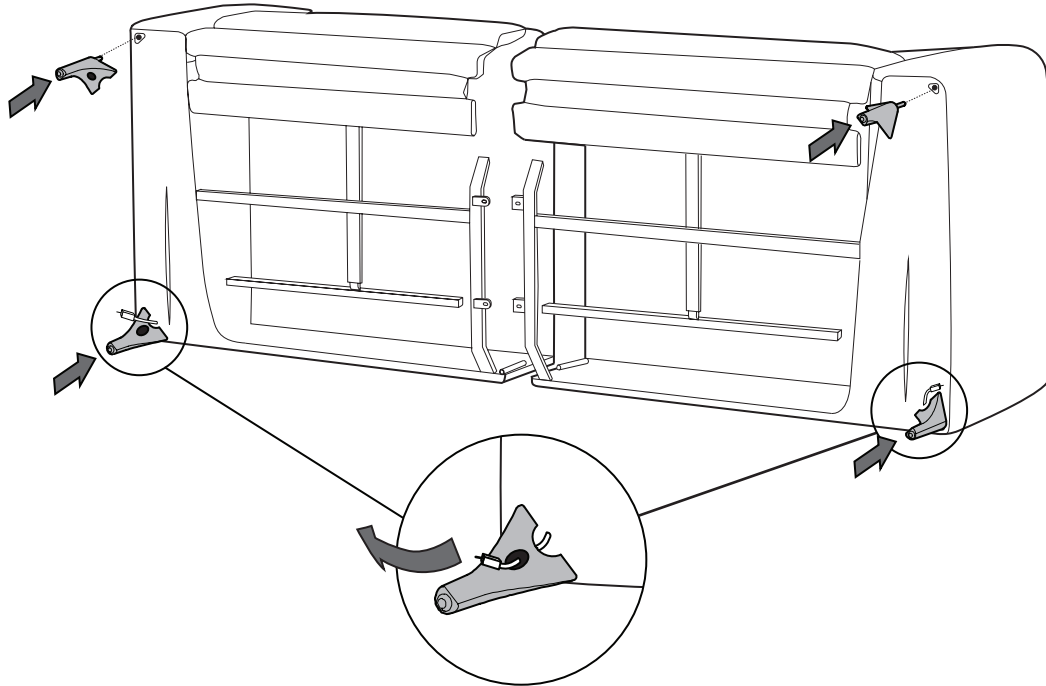

LEFT OR RIGHT

3

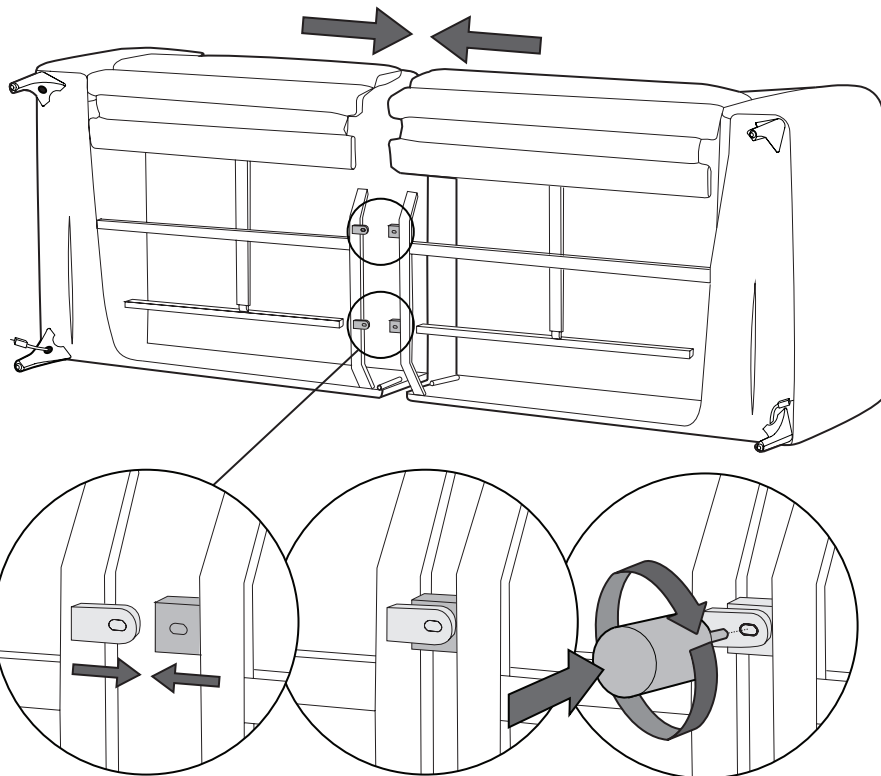
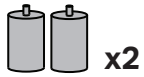

4

x1 (6mm)

x1

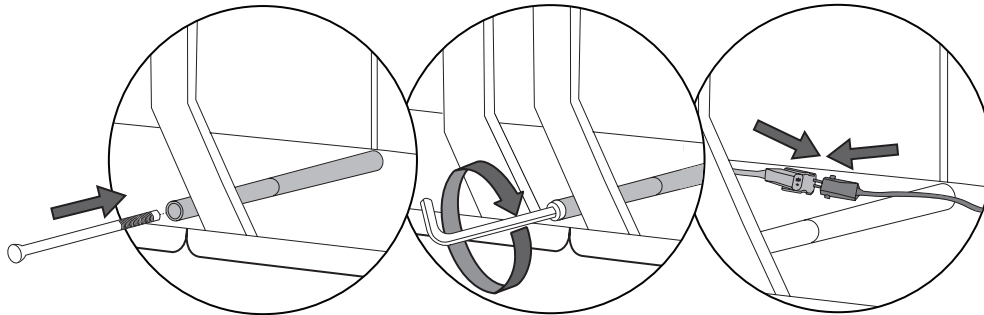
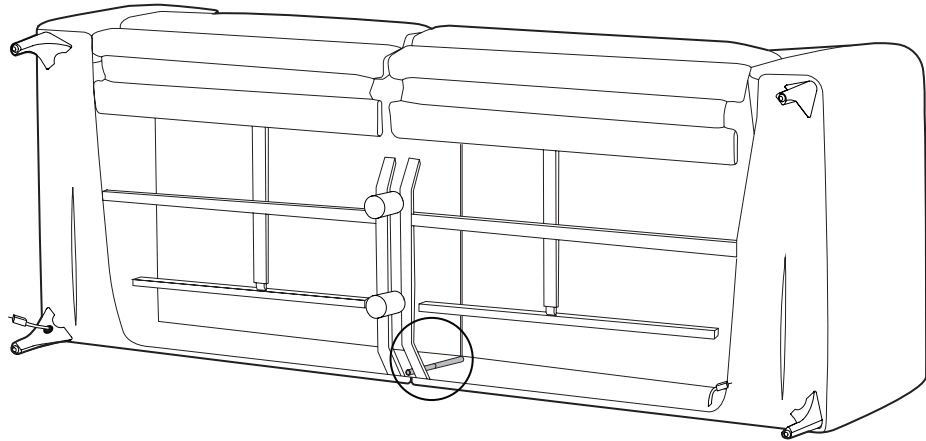

5



Recliner can be connected on left OR right side. Only connect ONE side to power supply.

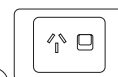
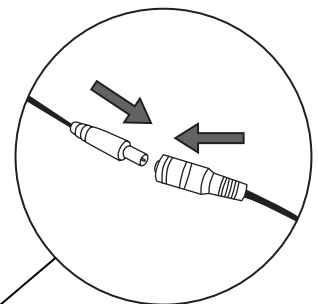
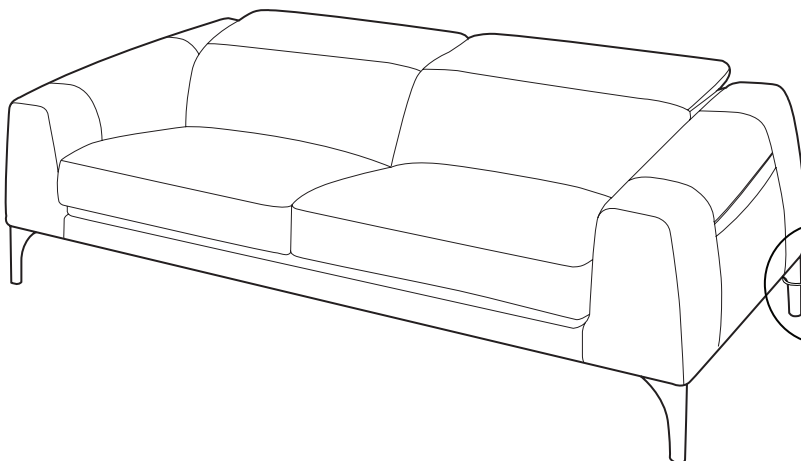

Accessories and Storage

INSTALLING ACCESSORIES

Refer to individual accessory package for assembly instructions.

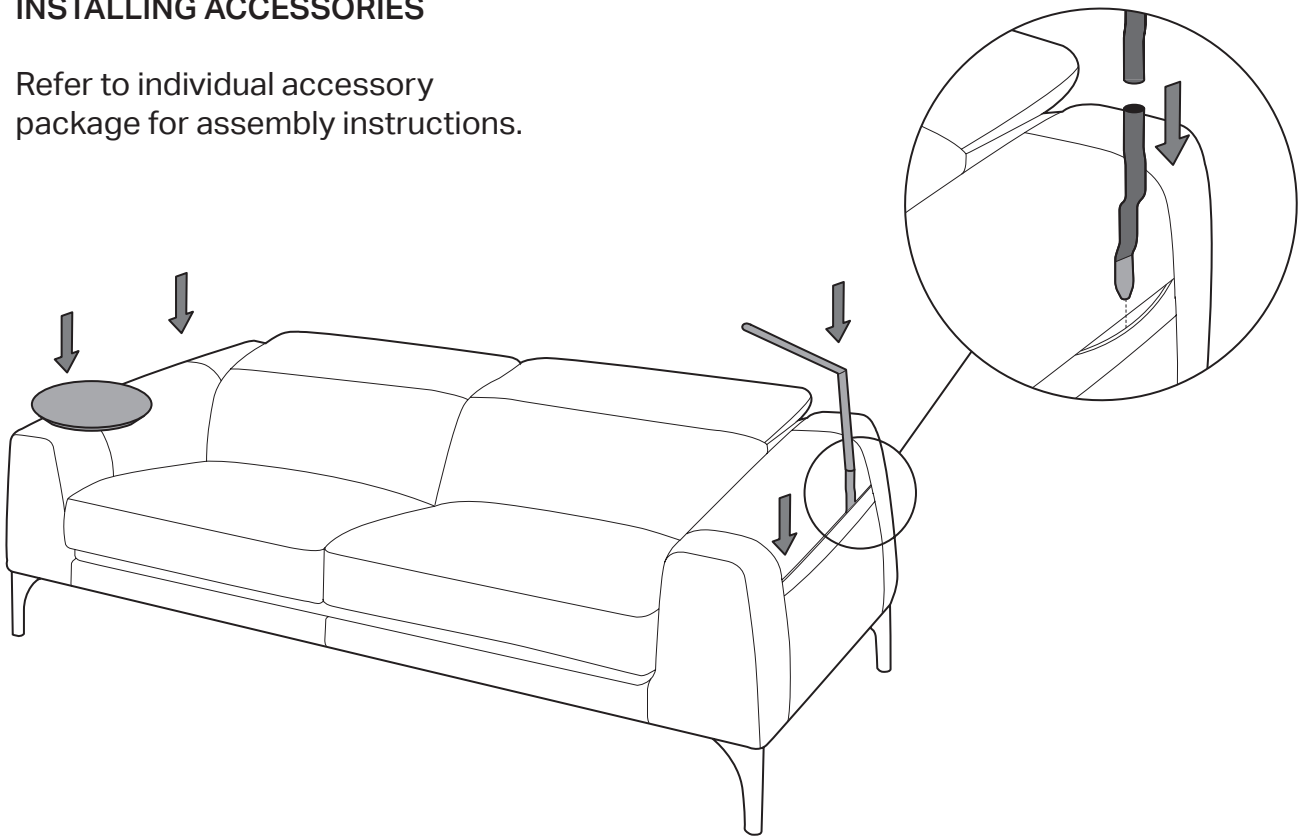

MAGNETIC STORAGE POCKET

Accessories can be installed in two locations on arm rest.

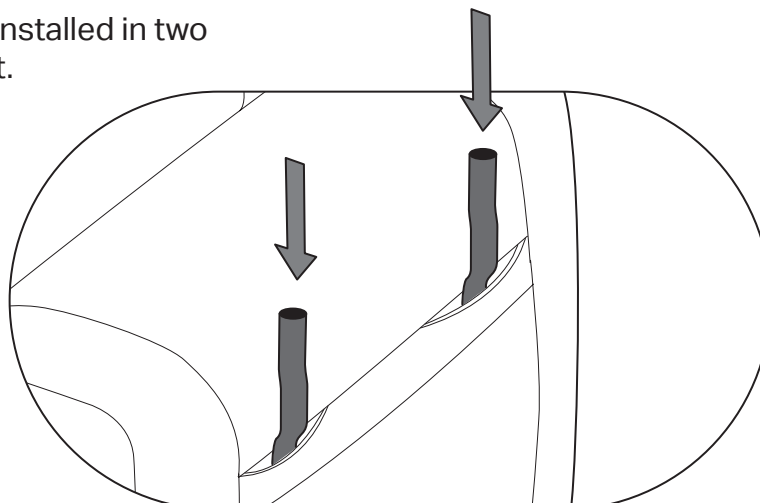

Connecting to Power

1



Do not connect Reo II to power until arms are assembled and modules connected.



Recliner can be connected on left OR right side. Only connect ONE side to power supply.

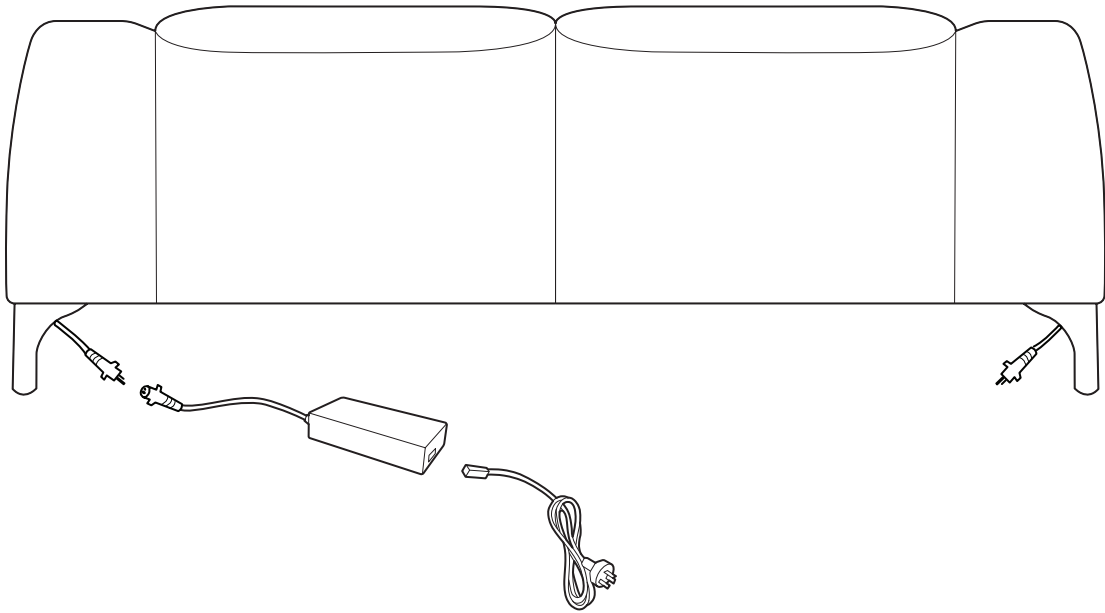

2

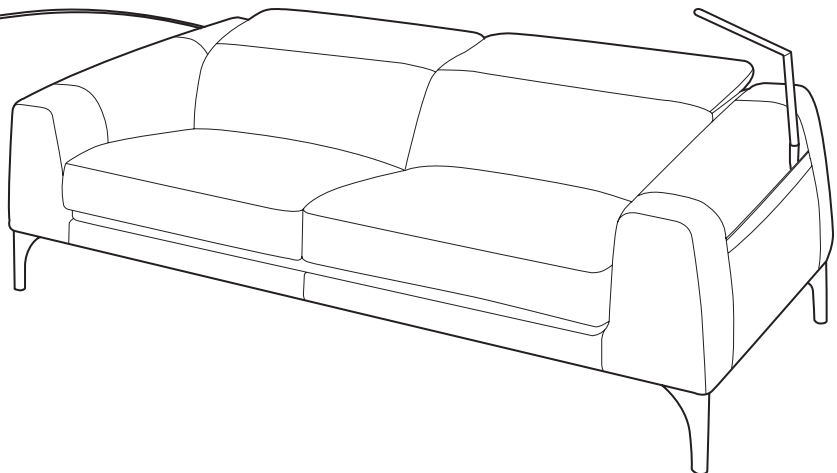
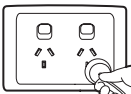

Connecting to Battery Pack: Smart



Choose one connector (left or right) to connect battery. Insert battery on the same side you will plug in to power.



Tuck the other connector back into the sofa, so that it does not get used in the future.

1

DISCONNECT FROM POWER

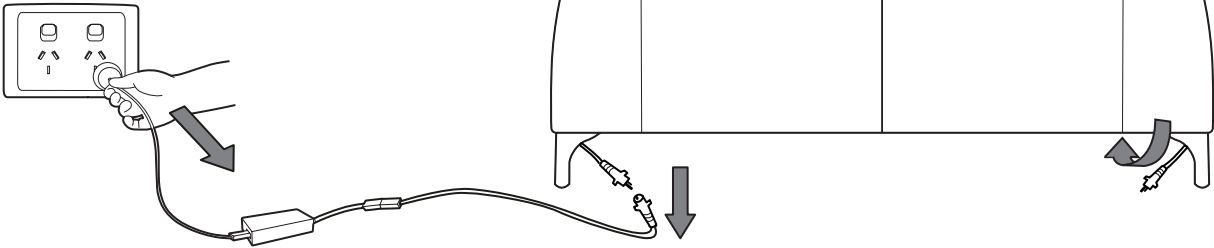

2

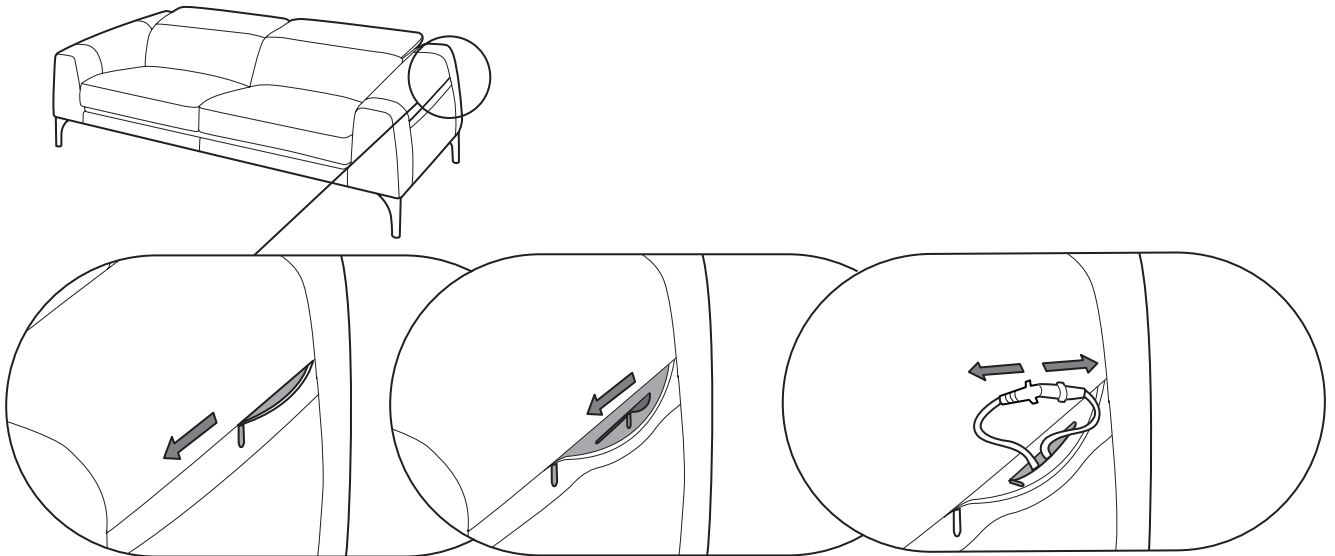

3

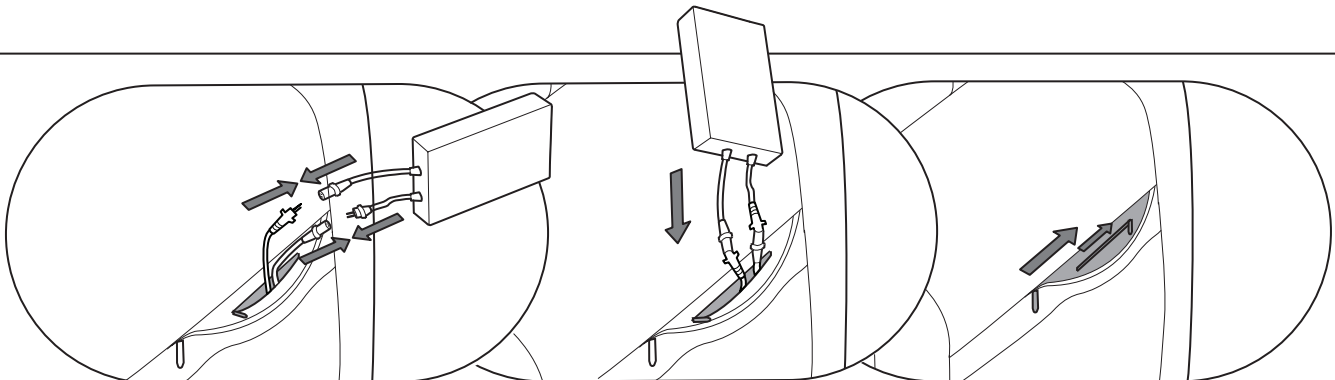

Charge battery via leg connector (see 'Connecting to Power'). Connect on same sofa side as battery. Opposite side will not charge.

Connecting to Battery Pack



Choose one connector (left or right) to connect battery. Insert battery on the same side you will plug in to power.



Tuck the other connector back into the sofa, so that it does not get used in the future.

1

DISCONNECT FROM POWER

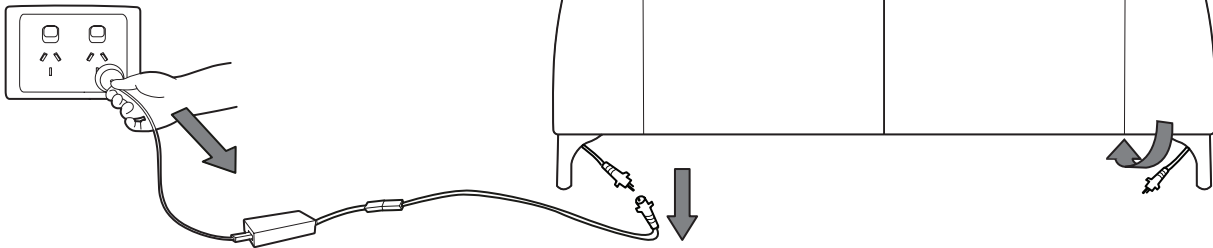

2

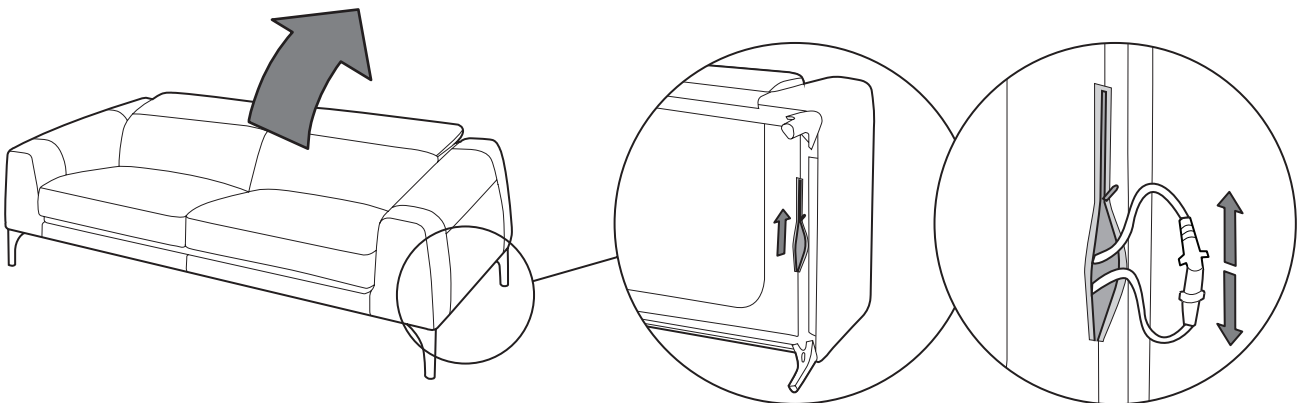

3

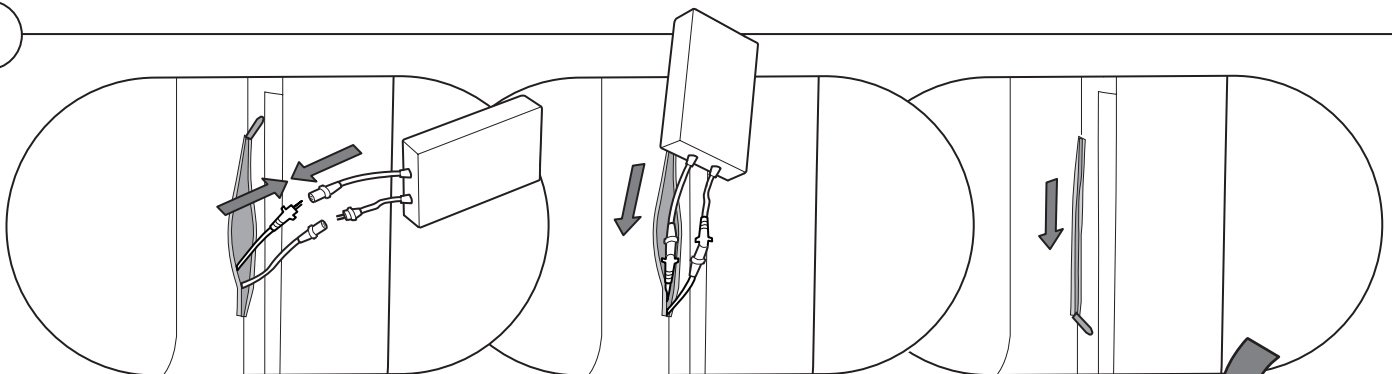

Charge battery via leg connector (see 'Connecting to Power'). Connect on same sofa side as battery. Opposite side will not charge.

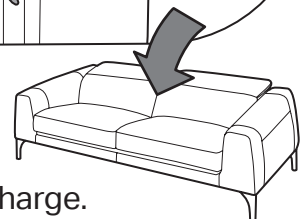

Operation

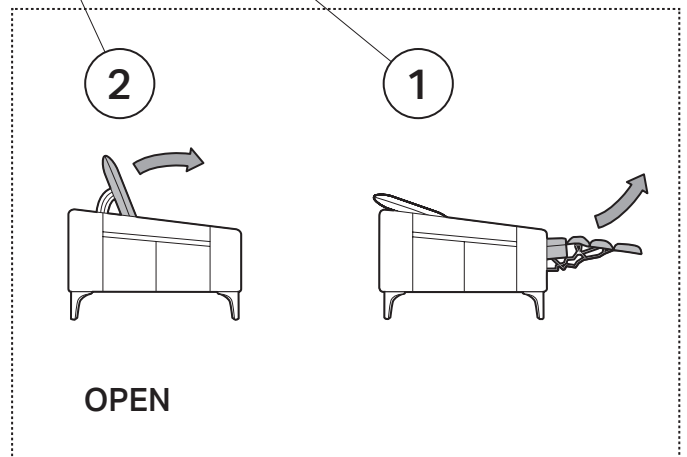
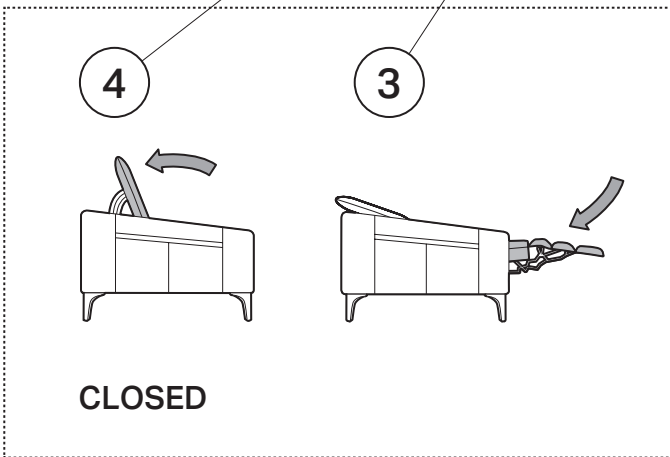
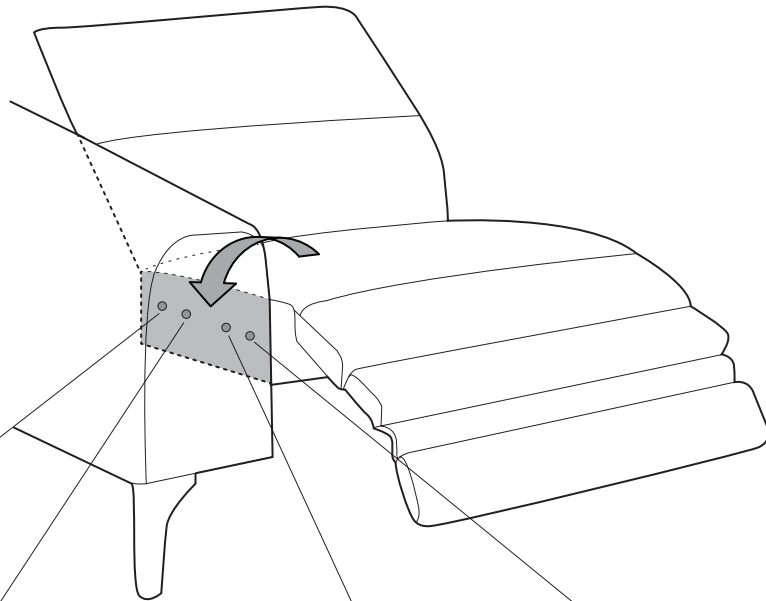

Frequently Asked Questions (FAQ)

Q Why doesn't my recliner module respond when a button is touched?

1 Your recliner module may not be connected to power. Follow these steps:

1. Ensure the power cable is plugged into the power outlet and the outlet is switched ON.
2. Ensure the power cable is connected to power supply and LED on the power supply is illuminated.
3. Ensure the extension power cable is connected to the power supply.
4. Ensure the extension power cable is connected to the rear of the recliner module.

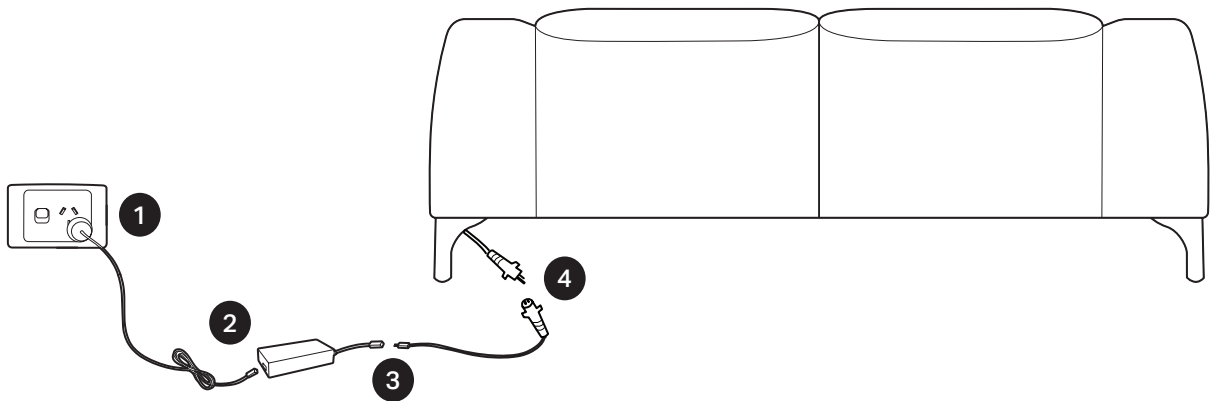

2 Your power supply may have overheated. Follow these steps:

1. Turn power OFF at the power socket, unplug power cable and wait for 15 minutes.
2. Re-connect power cable and turn power ON at the power socket.
3. Check that the light on the power supply is illuminated.

3 The cables used for battery charge may not have been reconnected. Follow these steps:
For Smart Recliners:

1. Turn power OFF at the power socket, unplug power cable.
2. Open arm pocket and internal zip.
3. Pull out internal cables. Check the two cables are connected, and not separated.

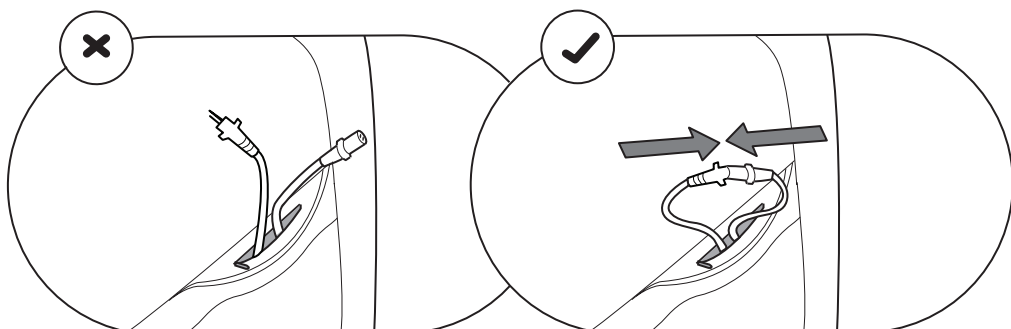

For Recliners:

1. Turn power OFF at the power socket, unplug power cable.
2. Turn over sofa and open zip on base of platform.
3. Pull out internal cables. Check the two cables are connected, and not separated.

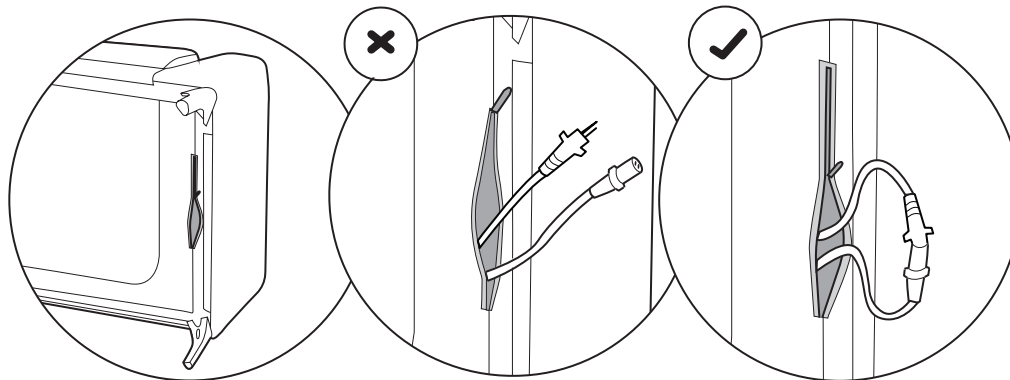

If the recliner module still doesn't respond when a button is touched, contact King Customer Care.

Q

Why won't the footrest of my recliner module close?

1

The footrest on your recliner module will not close if there is an obstruction / object blocking movement. Follow these steps:

1. Remove any objects from underneath the footrest such as toys or books.

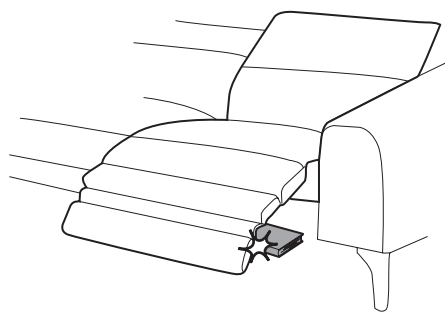

2. Check that there are no folds or lumps in the rug causing high spots under the footrest. These areas may obstruct movement.

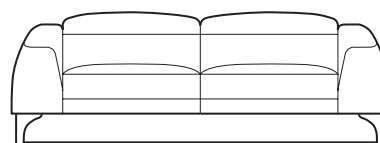
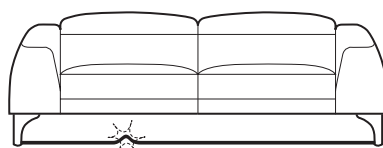

If your recliner module's footrest still doesn't close, contact King Customer Care.

2

The Reo II has a plastic protector over the arms of the recliner mechanism to cover potential pinch points in the moving components of the recliner. The plastic protector on the side of the mechanism may have come loose and is obstructing full range of movement. Follow these steps:

1. Turn power OFF at the power socket for each recliner module.
2. Check that the two pins of the protector are securely attached to the recliner mechanism. If this protector has come loose and is hanging down, it may be obstructing movement and will need to be re-attached. For more information contact King Customer Care.

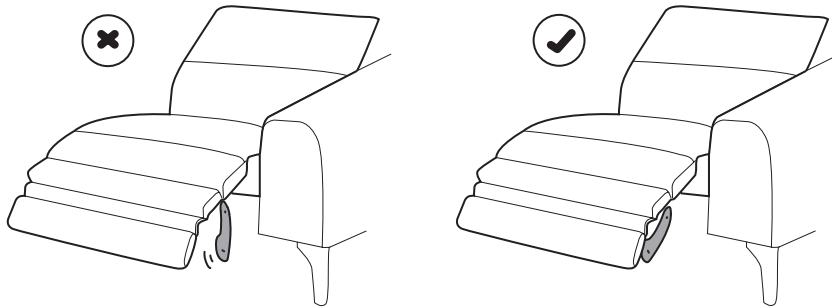

Q Why is my leather recliner module making a rubbing noise during operation?

During operation a rubbing noise may be present as the leather surfaces of your recliner modules slide past one another. Applying King-Care Leather Conditioner will not only ensure the soft, luxurious feel of your leather is maintained, but will allow the surfaces to move freely over each other and reduce any rubbing noises.

Apply King-Care Leather Conditioner to:

- 1) The sides of the lumbar
- 2) The sides of the seats
- 3) The insides of the arms

NOTE:

If you do not have King-Care Leather Conditioner, contact King Customer Care.

Q Why does my leather recliner module have slight wrinkles?

The Reo II is a luxurious, soft cushioned design which has been engineered for comfort. The multi-layered cushioning system combined with the natural stretch of high quality, soft, European leathers will result in some slight wrinkling of your recliner module covers – this is perfectly normal.

WARNING

Important:

Read the below instructions carefully before assembling and using this product.

IMPORTANT: ALWAYS FULLY RETRACT THE FOOTREST BEFORE SITTING IN OR GETTING OUT OF THE RECLINER.

To avoid damage to your recliner, the reclining function should only be operated when you are seated in the recliner. Any open footrests, which have a 15kg weight limit, must be closed before getting out of or into the seat. Sliding forward over the footrest to get out of the seat or getting into a fully reclined seat may cause damage to the mechanism of the recliner and can result in the sofa tipping forward in extreme cases. This built-in tipping point was specifically designed to preserve the integrity of the mechanism if too much pressure is placed on it and to avoid permanent damage. Damage caused by improper use of Recliners will not be covered under Warranty.

- Do not allow children to play with or on the unit or allow children to use the unit unsupervised. Serious injury or death could occur if head or body parts are trapped within or under the unit while it is being operated.
- Ensure children and pets are at a safe distance from the unit when operating the electric mechanism / moving parts.
- Keep hands and feet clear of moving parts at all times.
- Each unit should be operated only by the person sitting on it.
- Only use the electronic mechanism to operate the unit. Do not attempt to open the footrest by pulling on it.
- Always leave the unit in an upright and closed position when not in use to avoid children and pets crawling into any open cavities and becoming trapped under moving parts.
- Always disconnect the electrical cord attached to the unit from power before cleaning or moving the unit or when not in use for an extended period.
- Ensure the unit is clear of walls, furniture and other obstructions that may interfere with a clear path for operation. Ensure that no objects are left under the unit to avoid interference with the internal mechanisms.
- Do not use the unit if it is wet, in water, or around water or any liquid. Keep liquids away from unit. If liquids are spilled on the unit, disconnect from power immediately and wait until the spill is completely dry before reconnecting to power. Do not handle the plug or electric controls with wet hands.
- This product is for indoor residential use only.
- Use only a slightly damp cloth to clean metal parts of the mechanism. Before cleaning ensure the furniture has been disconnected from its power source.
- Ensure electrical wires are free from obstruction and not twisted or trapped. If any wires are damaged, turn off power supply and call King-Care.
- Do not attempt to disassemble or service the internal mechanism, motor or other parts. No customer serviceable parts inside.