

Jasper II Packages 7B

KING[®]
L I V I N G



kingliving.com

DT2018671 V1

Jasper II Packages 7B

Packages: 7B + 7B SMART* (*SMART Arms replace STD Arms)

Components: 1x P208, 1x P182, 1x P234, 1x C182, 1x C156, 2x C104,

3x A104, 1x A78, 1x A208, 2x B104, 3x B78

Shelf Options*: Standard or Charge

1x T104, 2x T78 (*Shelves not included – price extra)

Configurations:

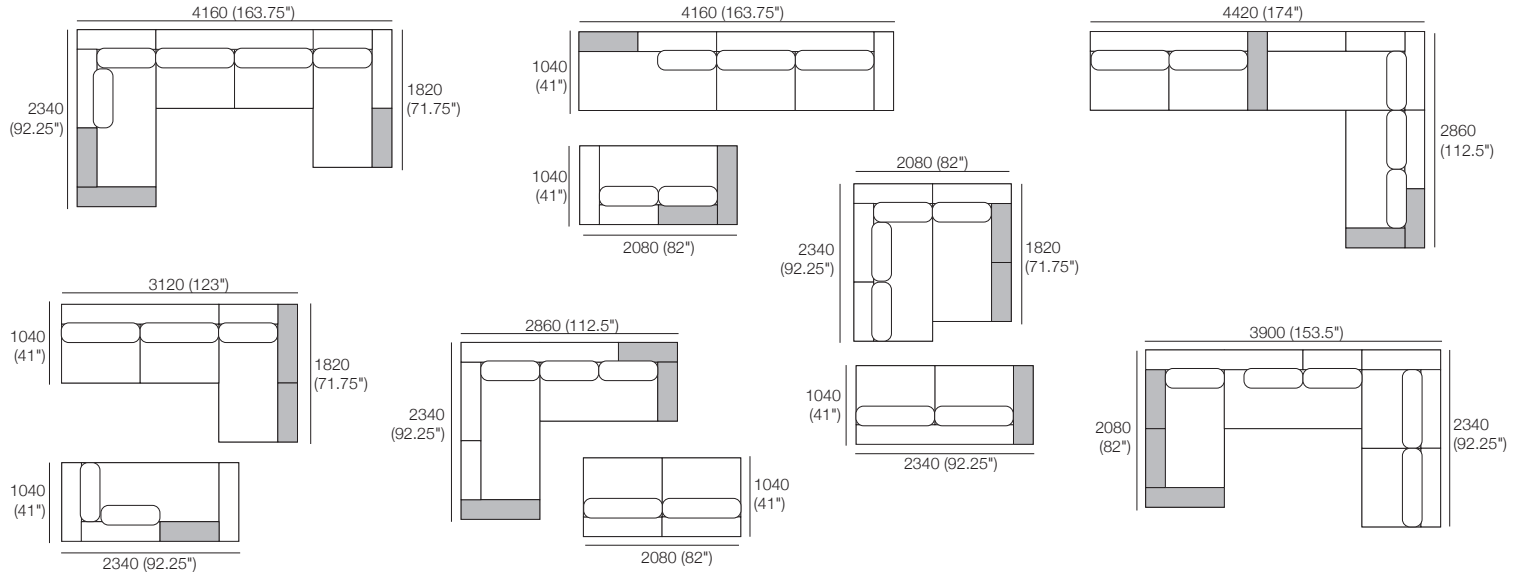

Effective November 2018. Use Magic Joiner M115. *Shelf Options: Standard or Charge (not included in package – price extra) available in selected King Living Timber Finishes. *SMART Packages: SMART Arms replace STD Arms. As King Living has a policy of continuous improvement, changes to products and specifications may be made without prior notice. Images and drawings are representative of design only. Accessories not included.

Jasper II Packages 7B

Packages: 7B SLH182 + 7B SLH182 SMART* (*SMART Arms replace STD Arms)

Components: 1x SBase 182 S78 LH, 1x P234, 1x P208, 1x C182, 2x C104,
1x A208, 3x A104, 1x A78, 2x B104, 3x B78

Shelf Options*: Standard or Charge

1x T104, 2x T78 (*Shelves not included – price extra)

Configurations:

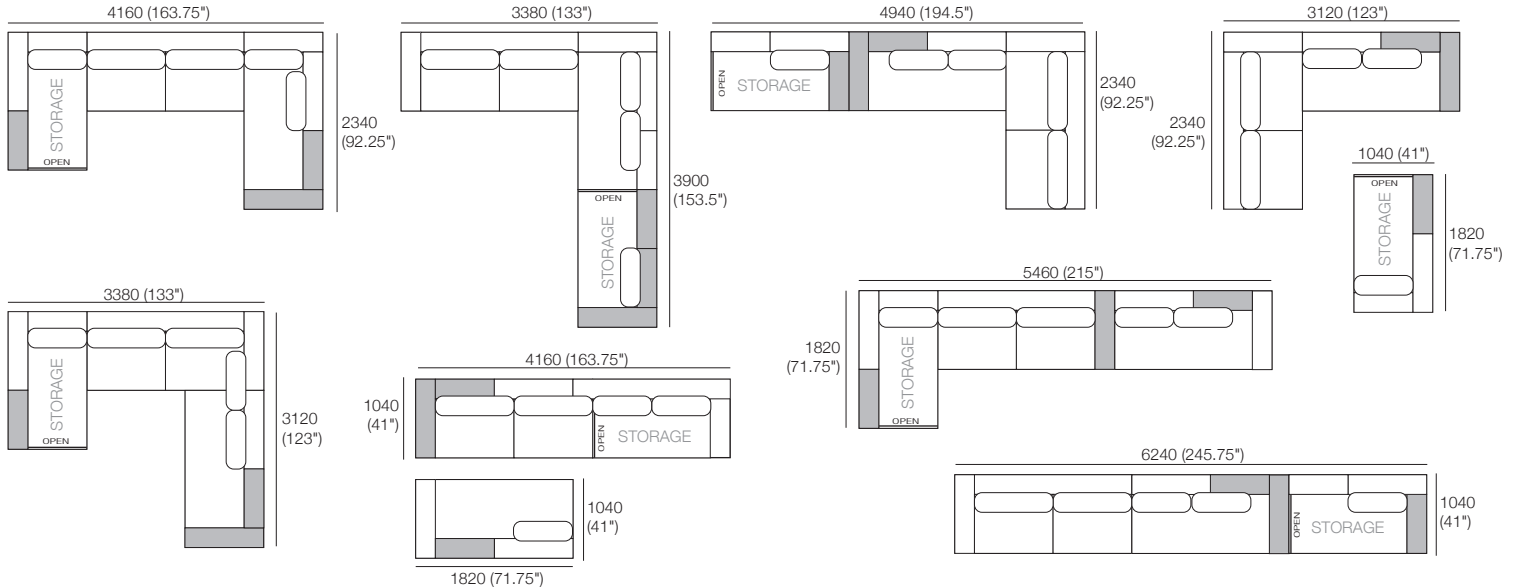

Effective November 2018. Use Magic Joiner M115. *Shelf Options: Standard or Charge (not included in package – price extra) available in selected King Living Timber Finishes. *SMART Packages: SMART Arms replace STD Arms. As King Living has a policy of continuous improvement, changes to products and specifications may be made without prior notice. Images and drawings are representative of design only. Accessories not included.

Jasper II Packages 7B

Packages: 7B SRH182 + 7B SRH182 SMART* (*SMART Arms replace STD Arms)

Components: 1x SBase 182 S78 RH, 1x P234, 1x P208, 1x C182, 2x C104,
1x A208, 3x A104, 1x A78, 2x B104, 3x B78

Shelf Options*: Standard or Charge

1x T104, 2x T78 (*Shelves not included – price extra)

Configurations:

